

Digital Cabinets

1 Glass Door Wine Refrigerator, 50 bottles, black

ITEM # _____

MODEL # _____

NAME # _____

SIS # _____

AIA # _____

720008 (WC50BK1Z)

1-glass door Wine Refrigerator for 50 bottles with black finish

Short Form Specification

Item No.

1 glass door refrigerator. Exterior in black painted steel. Dark interior with rounded corners and 45mm thick insulation.

Triple glass door, UV-treated with security lock.

Built-in refrigeration unit; LED digital temperature display. White LED internal light. Cell temperatures range: 6-18°C (single-zone refrigerator).

For ambient temperatures up to 38°C. HCFC and CFC free insulation and R600 refrigerant gas.

External prepainted steel. Max. capacity: up to 50 bottles (750ml - bordeaux bottle).

Main Features

- Model requires only 1 phase 230V supply and can be plugged straight into an existing power socket.
- Simple refrigeration system easily accessible from the rear of the units.
- Attractive presentation through glass door and lighting.
- Single-Zone refrigerator, from 6° to 18°C.
- Can storage up to 50 bottles (750ml - bordeaux bottle).
- Black UV-Treated glass door and dark storage area to not damage the wines.
- Unit features adjustable in height wooden shelves that allow different positioning of the bottles (vertical or horizontal).
- Vibration reduction system to avoid prematurely aging of the wines.
- Air circulation inside the cavity allows to keep ideal humidity level for corks and labels.
- Crystal white LED internal lights.
- Performance guaranteed at ambient temperatures of +38 °C.
- Unit features visual alarm.

Construction

- All models in range are finished in top quality materials to aid durability.
- LED digital temperature display.
- Triple glass door with security lock.

Sustainability



- CFC and HCFC free (ecological refrigerant type: R600a).

Included Accessories

- 4 of Wooden shelf for 1-glass door wine refrigerator, 50 bottles PNC 880550

Optional Accessories

- Wooden shelf for 1-glass door wine refrigerator, 50 bottles PNC 880550

APPROVAL: _____

Front

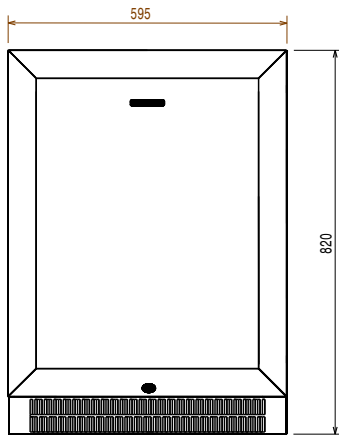

Side

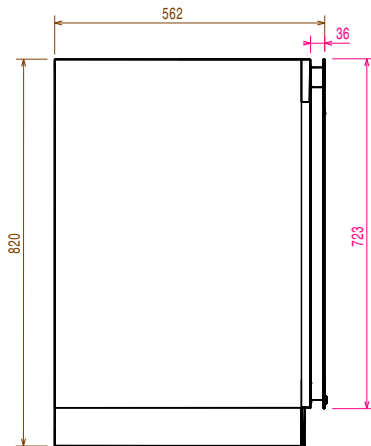

EI = Electrical inlet (power)

Top

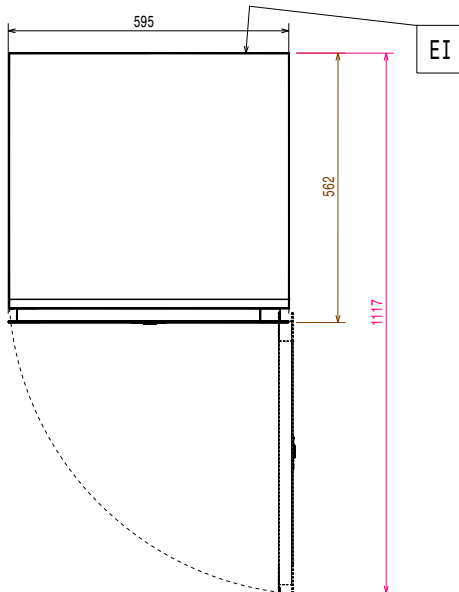

Electric

Supply voltage: 220 V/1N ph/50 Hz
 Electrical power max: 0.1 kW

Capacity:

Number and type of grids (included): 4+1 -

Key Information:

Net Volume: 146 lt
 External dimensions, Width: 595 mm
 External dimensions, Height: 820 mm
 Internal Dimensions, Width: 535 mm
 Internal Dimensions, Depth: 525 mm
 Internal Dimensions, Height: 805 mm
 Type of external material: Prepainted Steel

Refrigeration Data

Control type: Electronic
 Min/Max internal humidity: 85/
 Operating temperature min.: 6 °C
 Operating temperature max.: 18 °C
 Operating mode: Static
 Cooling unit: Built-In
 Defrost type: Manual

Sustainability

Refrigerant type: R600a
 GWP Index: 3
 Refrigerant weight: 35 g



Electrolux
PROFESSIONAL

Digital Cabinets 1 Glass Door Wine Refrigerator, 50 bottles, black

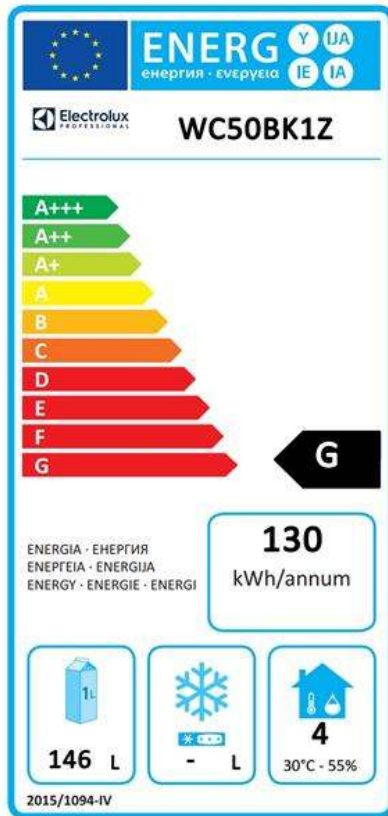

EU energy labelling from 1st July 2016

The European energy labelling scheme for professional refrigerators and freezers is based on requirements setting Minimum Energy Performance standards for commercial refrigeration cabinets sold within the EU.

These requirements are designed to drive energy efficiency and environmentally friendly approach for professionals. The European energy labelling scheme will apply to all manufacturers and importers who sell and market products within the EU and it is mandatory across Europe. Important: all products which consume energy above the minimum level will not be able to be sold within the EU from 1 July 2016.

SI 2020 No. 1528.

Important: all products which consume energy above the minimum level will not be able to be sold within the EU from 1 July 2016.



Digital Cabinets
1 Glass Door Wine Refrigerator, 50 bottles, black

The company reserves the right to make modifications to the products without prior notice. All information correct at time of printing.

2025.04.20